

Linear potentiometers Internal spring return, Slim body series

- + Measuring range 10 - 50 mm
- + Long mechanical life
- + Excellent repeatability <0.01 mm
- + Infinite resolution



Technical specifications

| | |
|----------------------------|--------------------|
| Measurement stroke | 10 to 50 mm |
| Linearity | ± %0,05 |
| Repeatability | < 0,01 mm |
| Resolution | Infinite |
| Resistance | 2 KOhm |
| Resistance tolerance | ± %20 |
| Recommended cursor current | <1 µA |
| Electrical connections | Cable 1m |
| Displacement speed | < 5 m/s |
| Mechanical life | 100 million cycles |
| Case dimensions | Ø18 mm |
| Case material | Anodized aluminium |
| Rod material | Stainless steel |
| Rod diameter | Ø5 mm |
| Mechanical fixing | Variable brackets |
| IP degree | IP 65 |
| Operating temperature | -20°C ... +80°C |
| Storage temperature | -30°C ... +90°C |

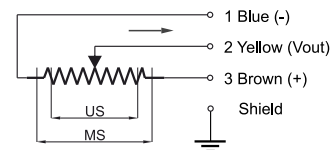
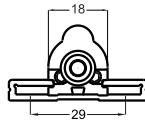
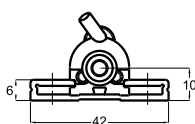
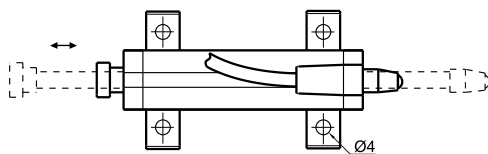
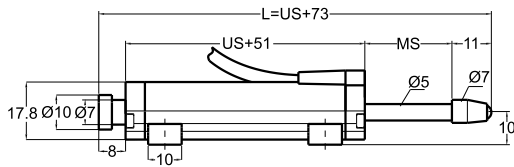

| | | | |
|---------------------------|----|----|-----|
| SLPIS (mm) | 10 | 25 | 50 |
| US (Usefull Stroke) | 10 | 25 | 50 |
| MS (Mechanical Stroke) | 14 | 29 | 54 |
| L (Total Length) | 83 | 98 | 123 |

| Model | Measurement stroke (mm) | Linearity (%) | Resistance (KOhm) | Connector / Cable |
|-----------------|-------------------------|------------------------|---|---|
| (example) SLPIS | 25 | D | 5K | 1M |
| SLPIS | 10 ... 50mm | D : ± %0,05 (standard) | 2K : 2 KOhm (10-25mm) 5K : 5 KOhm 10K : 10 KOhm | 1M : 1 meter cable 1M5 : 1,5 meter cable |