



MT2E1

Cable-Actuated Position Sensor

Incremental Encoder Output • Test Applications

Compact String Pot • 0-30 & 0-50 inch Stroke Range Options

Dual Axis 360° Mounting Bracket

Drop and Crash Test Applications

Aluminum & Polycarbonate Enclosure

The MT2E1 is the encoder-based member of our family of rugged, accurate miniature cable-actuated position transducers. The MT2E1 features a highly-tensioned heavy-duty measuring cable that was designed for the high-acceleration demands encountered in drop testing and automotive crash tests.

The MT2E1 was designed with 2-axis 360° rotation in its mounting bracket which allows for fast and simple installation in any direction.

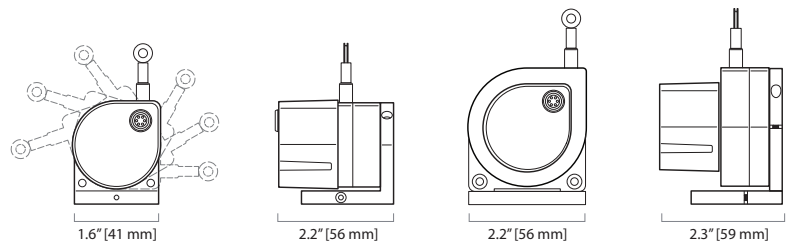

30 inch

50 inch

GENERAL

Full Stroke Range Options

0-30, 0-50 inches

Output Signal

incremental encoder

Accuracy

0.04% full stroke

Repeatability

± 0.02% full stroke

Resolution:

30-inch Range

316 ± 5 pulses per inch

50-inch Range

188 ± 2 pulses per inch

Measuring Cable

Ø.019-in. nylon-coated stainless steel

Enclosure Material

anodized aluminum

Sensor Cover Options

polycarbonate and aluminum

Sensor

optical incremental encoder

Weight, 30-inch

0.5 lb. max.

Weight, 50-inch

1.0 lb. max.

ELECTRICAL

Input Voltage, V_{in}

5 - 26 VDC

Input Current

50 mA (max, no load)

Output Driver

push-pull (sink/source, 20mA max.)

Output Voltage, V_{out}

$V_{out} = V_{in}$

Mating Plug

LEMO FGG.OB.304.CLAD52

MECHANICAL

Measuring Cable Tension

see ordering information

Maximum Acceleration

see ordering information

ENVIRONMENTAL

Operating Temperature

-32° to 158° F (0° to 70°C)

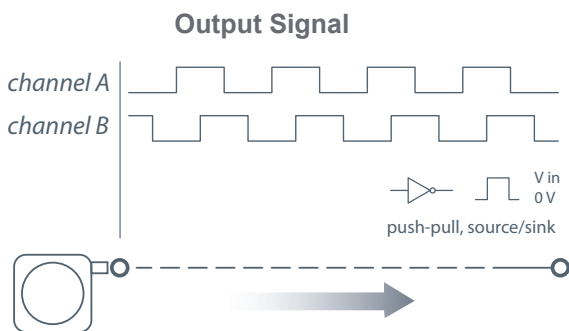

Fig. 1 - Outline Drawing, 30-inch range:

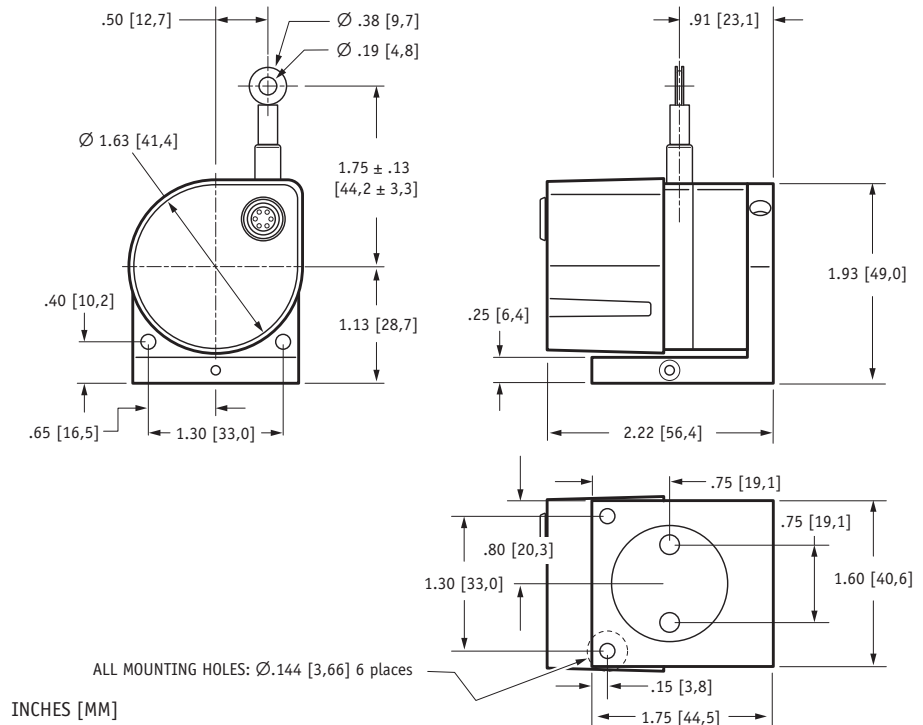
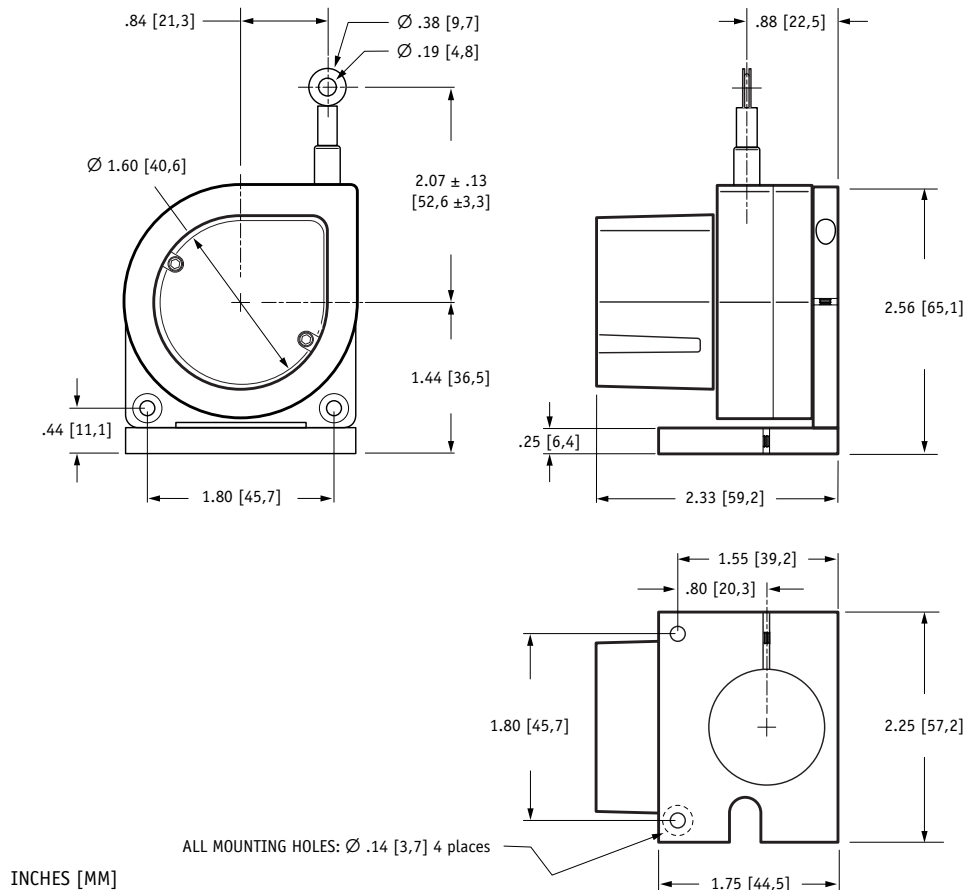

Fig. 2 - Outline Drawing, 50-inch range:



Ordering Information:

Model Number:

30-inch Ordering Guide

MT2E1 - 30 ^A - ^B - **316** - ^C
order code:

Sample Model Number:

MT2E1 - 30E - 33 - 316 - M1

- R** range: 30 inches
- A** measuring cable termination: eyelet
- B** measuring cable tension: 33 oz. (±6 oz.)
- C** electrical connection: end-mounted connector

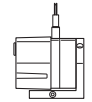

see fig. 1

50-inch Ordering Guide

MT2E1 - 50 ^A - ^B - **188** - ^C
order code:

Sample Model Number:

MT2E1 - 50E - 22 - 188 - M1

- R** range: 50 inches
- A** measuring cable termination: eyelet
- B** measuring cable tension: 22 oz. (±6 oz.)
- C** electrical connection: end-mounted connector

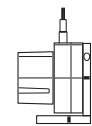

see fig. 2

Measuring Cable Termination:

A *order code:*

E

Eyelet

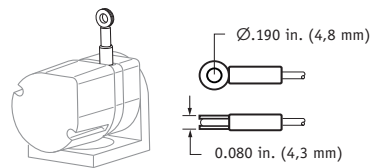

L

Leader Cable (24 in. long)

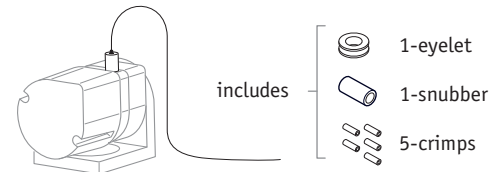

Measuring Cable Tension:

B *order code:*

9

14

33

30-inch range option:	9 (±3) oz.	14 (±5) oz.	33 (±10) oz.
max. cable acceleration:	99 g	136 g	136 g
spring cycle-life, 80% extension:	≥ 1 million	150,000	75,000
spring cycle-life, 50% extension:	≥ 1 million	≥ 1 million	≥ 1 million

B *order code:*



9

22

50-inch range option:	9 (±3) oz.	22 (±7) oz.
max. cable acceleration:	46 g	68 g
spring cycle-life, 80% extension:	≥ 1 million	150,000
spring cycle-life, 50% extension:	≥ 1 million	≥ 1 million

Ordering Information (cont.):

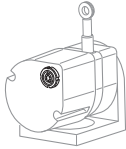
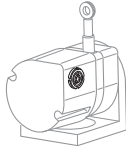
Electrical Connection:

order code:	M1	M1A	M2	M2A	M3	M3A
sensor cover:	polycarbonate	aluminum	polycarbonate	aluminum	polycarbonate	aluminum
electrical connection:		end-mount connector <i>mating plug included</i>		side-mount connector <i>mating plug included</i>		top-mount connector <i>mating plug included</i>

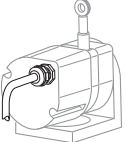
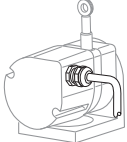
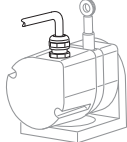
order code:	C1	C1A	C2	C2A	C3	C3A
sensor cover:	polycarbonate	aluminum	polycarbonate	aluminum	polycarbonate	aluminum
electrical connection:		end-mount instrumentation cable <i>15-ft. long, 24 gauge shielded</i>		side-mount instrumentation cable <i>15-ft. long, 24 gauge shielded</i>		top-mount instrumentation cable <i>15-ft. long, 24 gauge shielded</i>

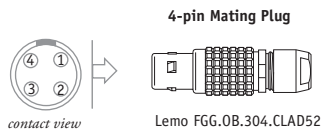

pin#	signal
1	input voltage (V+)
2	common (gnd.)
3	channel A
4	channel B

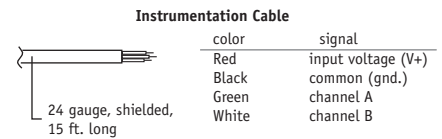

Accessories:

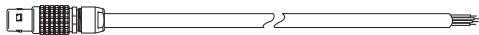

Part Number

9603957-0015

Description

15 ft. long cordset. Includes mating connector with 15 ft., 24 gauge, shielded multiconductor cable. Signals: V+, Gnd, Channel A, Channel B

NORTH AMERICA
Measurement Specialties, Inc.
a TE Connectivity Company

Tel +1-800-423-5483
customer.care@te.com

te.com/sensorsolutions

Measurement Specialties Inc. a TE Connectivity company

Measurement Specialties, TE Connectivity, TE Connectivity (logo) and Every Connection Counts are trademarks. All other logos, products and/or company names referred to herein might be trademarks of their respective owners.

The information given herein, including drawings, illustrations and schematics which are intended for illustration purposes only, is believed to be reliable. However, TE Connectivity makes no warranties as to its accuracy or completeness and disclaims any liability in connection with its use. TE Connectivity's obligations shall only be as set forth in TE Connectivity's Standard Terms and Conditions of Sale for this product and in no case will TE Connectivity be liable for any incidental, indirect or consequential damages arising out of the sale, resale, use or misuse of the product. Users of TE Connectivity products should make their own evaluation to determine the suitability of each such product for the specific application.

© 2019 TE Connectivity Ltd. family of companies All Rights Reserved.